



PVC-U Ball Valve type 546 Pro
With solvent cement sockets PVC-U ASTM
Inclusive 2 threaded valve ends NPT

Model:

- Lockable lever as standard
- Ball seals PTFE
- Integrated stainless steel mounting inserts
- Z-dimension, valve end and union nut **are compatible** with type 546 (1st Generation)

Option:

- Interface module for position feedback sensor with LED (PNP, NPN and NAMUR)
- Manual spring return lever ("Dead man") (DN10-25)
- Pneumatic or electric actuators from GF
- Individual configuration of the valve possible

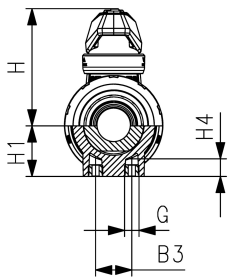
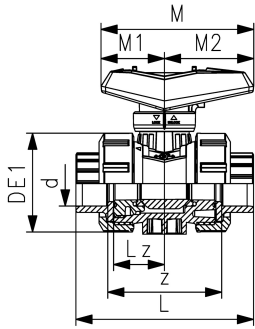

d (mm)	DN (mm)	Size (inch)	PN (bar)	kv-value ($\Delta p=1$ bar) (L/min)	EPDM Code	SP	Weight (kg)	FKM Code	SP	Weight (kg)
16	10	3/8	16	71	161 546 341	1	0.157	161 546 351	1	0.184
20	15	1/2	16	185	161 546 342	1	0.233	161 546 352	1	0.200
25	20	3/4	16	350	161 546 343	1	0.245	161 546 353	1	0.342
32	25	1	16	700	161 546 344	1	0.483	161 546 354	1	0.486
40	32	1 1/4	16	1000	161 546 345	1	0.796	161 546 355	1	0.740
50	40	1 1/2	16	1600	161 546 346	1	1.089	161 546 356	1	0.850
63	50	2	16	3100	161 546 347	1	1.922	161 546 357	1	1.934
75	65	2 1/2	16	5000	161 546 348	1	4.363	161 546 358	1	4.900
90	80	3	16	7000	161 546 349	1	5.376	161 546 359	1	7.400
110	100	4	16	11000	161 546 350	1	9.633	161 546 360	1	9.707

d (mm)	B3 (mm)	DE1 (mm)	G (mm)	H (mm)	H1 (mm)	H4 (mm)	L (mm)	Lz (mm)	M (mm)	M1 (mm)	M2 (mm)	z (mm)
16	25	50	M6	60.5	27	12	92	28	82	35	47	64
20	25	50	M6	60.5	27	12	95	28	82	35	47	64
25	25	58	M6	74.0	30	12	110	33	106	44	62	72
32	25	68	M8	80.0	36	12	123	36	106	44	62	79
40	45	84	M8	95.0	44	15	146	43	131	57	74	94
50	45	97	M8	101.5	51	15	157	45	131	57	74	95
63	45	124	M8	116.5	64	15	183	51	152	66	86	107
75	70	166	M8	169.0	85	15	233	68	270	64	205	144
90	70	200	M8	180.0	105	15	254	71	270	64	205	151
110	120	238	M12	194.0	123	22	301	82	326	71	205	174

The technical data are not binding. They neither constitute expressly warranted characteristics nor guaranteed properties nor a guaranteed durability. They are subject to modification. Our General Terms of Sale apply.

Georg Fischer Piping Systems Ltd, Postfach, CH-8201 Schaffhausen/Switzerland Phone +41 -(0)52-631 1111 e-mail: info.ps@georgfischer.com Internet: <http://www.gfps.com>