



SYGEF Standard PVDF Ball valve type 546 Pro with PPA FO (Fail safe to open)
With butt fusion spigots PVDF IR-Plus ISO
Without manual override
5.6 bar (Standard)

Model:

- Control pressure supply through integrated NAMUR interface according VDI/VDE 3845
- Full plastic solution (actuator housing made of PP-GF)
- Visual position indicator
- Integrated stainless steel mounting inserts
- z-dimension, valve end and union nut are compatible with type 546 (1st Generation)

Option:

- Position feedback through double sensor with LED (PNP, NPN and NAMUR)
- Positioner RPC, RPC D, RPC PID
- Individual configuration of valves possible

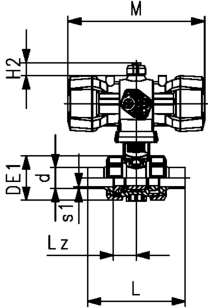
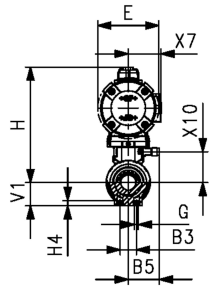
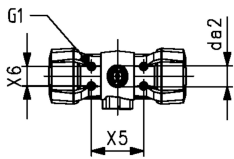

d (mm)	DN (mm)	Size (inch)	PN (bar)	kv-value ($\Delta p=1$ bar) (l/min)	FKM Code	SP	Weight (kg)
20	15	½	10	185	199 255 853	1	1.420
25	20	¾	10	350	199 255 854	1	1.250
32	25	1	10	700	199 255 855	1	1.310
40	32	1 ¼	10	1000	199 255 856	1	2.450
50	40	1 ½	10	1600	199 255 857	1	2.790
63	50	2	10	3100	199 255 858	1	3.790

d (mm)	Actuator	B3 (mm)	B5 (mm)	da2 (mm)	DE1 (mm)	E (mm)	G (mm)	G1 (mm)	H (mm)	H2 (mm)	H4 (mm)	L (mm)	Lz (mm)	M (mm)	s1 (mm)
20	PPA15	25	16.2	33	50	74	M6	M5	155	20	12	130	28	159	1.9
25	PPA15	25	17.5	33	58	74	M6	M5	159	20	12	143	33	159	2.3
32	PPA15	25	17.5	33	68	94	M6	M5	178	20	12	150	36	211	3.0
40	PPA40	45	23.3	33	84	94	M8	M5	184	20	15	171	43	211	3.7
50	PPA40	45	23.3	33	97	120	M8	M5	213	20	15	191	45	246	4.6
63	PPA40	45	24.3	33	124	120	M8	M5	228	20	15	220	51	246	5.8

d (mm)	V1 (mm)	X5 (mm)	X6 (mm)	X7 (mm)	X10 (mm)
20	27	80	30	43	38.0
25	30	80	30	43	41.9
32	36	80	30	51	47.0
40	44	80	30	51	53.5
50	51	80	30	62	62.8
63	64	80	30	62	77.0

The technical data are not binding. They neither constitute expressly warranted characteristics nor guaranteed properties nor a guaranteed durability. They are subject to modification. Our General Terms of Sale apply.

Georg Fischer Piping Systems Ltd, Postfach, CH-8201 Schaffhausen/Switzerland Phone +41 -(0)52-631 1111 e-mail:
 info.ps@georgfischer.com Internet: <http://www.gfps.com>