

## COOL-FIT 2.0/4.0 Flange adaptor

### Model:

- PE100 SDR11, metric
- Suitable for flange connections to metric and/or ANSI/ASME B16.5
- Type 1 without chamfer, Type 2 with chamfer
- Profile flange gasket EPDM: metric No. 48 44 07, ANSI No. 48 44 05.
- Including insulation half shells
- Separate Fittings type A needed for joining

### Note:

Backing ring and gasket not included

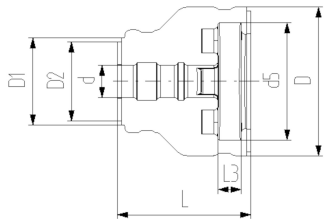
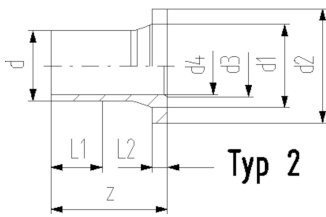
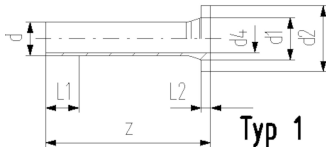

d (mm)	DN (mm)	Type	Code	Weight (kg)
32	25	1	<b>738 710 008</b>	0.320
32	25	1	<b>738 710 108</b>	0.320
40	32	1	<b>738 710 009</b>	0.480
40	32	1	<b>738 710 109</b>	0.480
50	40	1	<b>738 710 010</b>	0.620
50	40	1	<b>738 710 110</b>	0.620
63	50	1	<b>738 710 011</b>	0.910
75	65	2	<b>738 710 012</b>	1.220
90	80	2	<b>738 710 013</b>	1.650
90	80	2	<b>738 710 113</b>	1.650
110	100	2	<b>738 710 014</b>	2.390
140	125	2	<b>738 710 016</b>	3.660
160	150	2	<b>738 710 017</b>	4.800
225	200	2	<b>738 710 020</b>	9.600

d (mm)	D (mm)	d1 (mm)	D1 (mm)	d2 (mm)	D2 (mm)	d3 (mm)	d4 (mm)	d5 (mm)	L (mm)	L1 (mm)	L2 (mm)	L3 (mm)	Standard	z (mm)
32	135	40	90	68			26	121	162	36	10	26	Metric	190
32	135	40	90	63	63		26	121	162	36	10	26	ANSI	190
40	170	50	110	78	90		32	146	165	40	11	28	Metric	197
40	170	50	110	73	73		32	146	165	40	11	28	ANSI	197
50	180	61	110	88	90		40	156	178	44	12	30	Metric	214
50	180	61	110	82	82		40	156	178	44	12	30	ANSI	214
63	200	75	125	102	110		51	171	230	48	14	32	Metric, ANSI	270
75	220	89	140	122	125	66	61	191	232	55	16	34	Metric, ANSI	279
90	240	105	160	138	140	78	73	206	245	62	17	35	Metric	299
90	240	105	160	133	133	78	73	206	245	62	17	35	ANSI	299
110	270	125	180	158	160	100	90	235	254	72	18	36	Metric, ANSI	320
140	300	155	225	188	200	127	127	256	299	84	25	38	Metric, ANSI	383
160	358	174	259	213	213	151	131	295	332	90	25	34	Metric, ANSI	412
225	423	233	325	268	268	209	184	354	383	110	32	37	Metric, ANSI	483

The technical data are not binding. They neither constitute expressly warranted characteristics nor guaranteed properties nor a guaranteed durability. They are subject to modification. Our General Terms of Sale apply.

Georg Fischer Piping Systems Ltd, Postfach, CH-8201 Schaffhausen/Switzerland Phone +41 -(0)52-631 1111 e-mail: info.ps@georgfischer.com Internet: <http://www.gfps.com>