

ecoFIT Ball valve type 546 Pro
With butt fusion spigots PE100 SDR11 metric

Model:

- Lockable lever as standard
- Ball seals PTFE
- Integrated stainless steel mounting inserts
- Z-dimension, valve end and union nut **are compatible** with type 546 (1st Generation)

Option:

- Interface module for position feedback sensor with LED (PNP, NPN and NAMUR)
- Manual spring return lever ("Dead man") (DN10-25)
- Pneumatic or electric actuators from GF
- Individual configuration of the valve possible

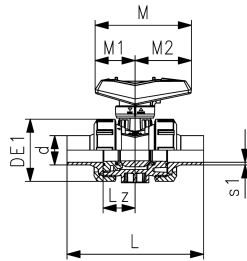
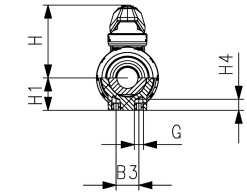

d (mm)	DN (mm)	Size (inch)	PN (bar)	kv-value ($\Delta p=1$ bar) (l/min)	EPDM Code	SP	Weight (kg)	FKM Code	SP	Weight (kg)
20	15	½	16	185	161 546 782	1	0.151	161 546 792	1	0.153
25	20	¾	16	350	161 546 783	1	0.231	161 546 793	1	0.220
32	25	1	16	700	161 546 784	1	0.329	161 546 794	1	0.333
40	32	1 ¼	16	1000	161 546 785	1	0.583	161 546 795	1	0.586
50	40	1 ½	16	1600	161 546 786	1	0.817	161 546 796	1	0.826
63	50	2	16	3100	161 546 787	1	1.505	161 546 797	1	1.517

d (mm)	B3 (mm)	DE1 (mm)	G (mm)	H (mm)	H1 (mm)	H4 (mm)	L (mm)	Lz (mm)	M (mm)	M1 (mm)	M2 (mm)	s1 (mm)
20	25	50	M6	60.5	27	12	130	28	82	35	47	1.9
25	25	58	M6	74.0	30	12	143	33	106	44	62	2.3
32	25	68	M6	80.0	36	12	150	36	106	44	62	3.0
40	45	84	M8	95.0	51	15	171	43	131	57	74	3.7
50	45	97	M8	101.5	44	15	191	45	131	57	74	4.6
63	45	124	M8	116.5	64	15	220	51	152	66	86	5.8

The technical data are not binding. They neither constitute expressly warranted characteristics nor guaranteed properties nor a guaranteed durability. They are subject to modification. Our General Terms of Sale apply.

Georg Fischer Piping Systems Ltd, Postfach, CH-8201 Schaffhausen/Switzerland Phone +41 -(0)52-631 1111 e-mail: info.ps@georgfischer.com Internet: <http://www.gfps.com>