



**Wafer-style intermediate installation butterfly valve type 565 PE**  
**With pneumatic actuator - double acting (DA)**  
**Flange standard ANSI / ASTM / ASME**  
**Suitable for ABS, PVC-U, PVC-C, ecoFIT, COOL-FIT and PROGEF Systems**

**Model:**

- Installation length: EN558 row 20, ISO 5752 row 20, API 609 table 2
- Flange standard: ANSI/ASME B 16.5 Class 150, BS 1560: 1989 Class 125/150; BS 4504 PN10
- For easy installation and removal
- Control time 0-90° 5-6s
- Control pressure 5.6 bar
- Suitable for water and water treatment applications (e.g. sea water, drinking water and industrial water)

**Option:**

- Individual configuration of the valve possible
- Double sensor for electrical position feedback incl. LED feedback
- Gear box or electric actuators

**Note:**

For some material combination (e.g. valves with PE/PP pipes) special flange adapters are needed. Please check the "Perfect flange connection tool" on [www.gfps.com](http://www.gfps.com)

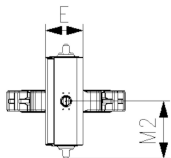
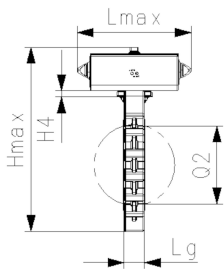
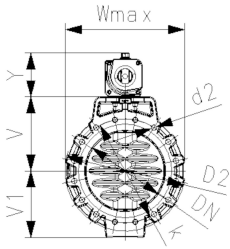

d (mm)	DN (mm)	Size (inch)	PN (bar)	kv-value ( $\Delta p=1$ bar) (L/min)	Acc.to ISO 5211	EPDM Code	Weight (kg)
355	350	14	10	148808	F14	<b>199 556 600</b>	50.600
400	400	16	10	185266	F14	<b>199 556 601</b>	72.900

d (mm)	DN (mm)	d2 (mm)	U (mm)	V (mm)	H4 (mm)	Hmax (mm)	V1 (mm)	Y (mm)	Q2 (mm)	Lg (mm)	Lmax (mm)	D2 (mm)	k (mm)	M1 (mm)
355	350	28.6	180	332	29	820	290	198	331	78	479.4	517	476.3	239.7
400	400	28.6	180	367	29	912	329	216	379	102	567.1	579	539.8	283.6

d (mm)	DN (mm)	M2 (mm)	E (mm)	Wmax (mm)	d2
355	350	239.7	168	530.0	UNC 1"
400	400	283.6	186	590.5	UNC 1"

The technical data are not binding. They neither constitute expressly warranted characteristics nor guaranteed properties nor a guaranteed durability. They are subject to modification. Our General Terms of Sale apply.

Georg Fischer Piping Systems Ltd, Postfach, CH-8201 Schaffhausen/Switzerland Phone +41 -(0)52-631 1111 e-mail: [info.ps@georgfischer.com](mailto:info.ps@georgfischer.com) Internet: <http://www.gfps.com>