

PROGEF Standard bend 90° S8.3/SDR17.6

Model:

- Material: PP-H
- Conventional butt-welding according to DVS 2207
- IR = Infrared welding compatible
- New code numbers in dimensions d125-d315 not available yet, please refer to the existing code numbers 727018415-727018423.

* Material:PP-R



1



2

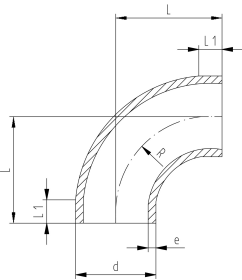

d	SDR	PN	FM	Type	Code	Weight	L	L1	R	e
(mm)		(bar)				(kg)	(mm)	(mm)	(mm)	(mm)
50	17.6	6	IR	1	727 018 635	0.050	58	21	37.00	3.0
63	17.6	6	IR	1	727 018 636	0.081	66	21	45.00	3.8
75	17.6	6	IR	2	727 018 412	0.128	75	21	71.25	4.8
90	17.6	6	IR	2	727 018 413	0.222	90	22	85.50	5.7
110	17.6	6	IR	2	727 018 414	0.396	110	25	104.50	6.9
125	17.6	6	IR	2	727 018 215	0.625	145	34	126.00	7.1
140	17.6	6	IR	2	727 018 216	0.880	162	38	142.00	8.0
160	17.6	6	IR	2	727 018 217	1.273	183	40	162.00	9.1
180	17.6	6	IR	2	727 018 218	1.720	200	38	182.00	10.2
200	17.6	6	IR	2	727 018 219	2.329	220	40	202.00	11.4
225	17.6	6	IR	2	727 018 220	3.270	245	41	227.00	12.8
250	17.6	6	IR	2	727 018 221	4.629	280	51	252.00	14.2
280	17.6	6	IR	2	727 018 222	6.410	310	52	282.00	15.9
315	17.6	6	IR	2	727 018 223	9.173	350	61	318.00	17.9
*	355	17.6	6	2	727 018 424	11.640	345	70	330.00	21.2
*	400	17.6	6	2	727 018 425	15.200	365	70	350.00	23.9
*	450	17.6	6	2	727 018 426	22.240	425	70	400.00	26.9
*	500	17.6	6	2	727 018 427	31.020	470	90	445.00	29.8

The technical data are not binding. They neither constitute expressly warranted characteristics nor guaranteed properties nor a guaranteed durability. They are subject to modification. Our General Terms of Sale apply.

Georg Fischer Piping Systems Ltd, Postfach, CH-8201 Schaffhausen/Switzerland Phone +41 -(0)52-631 1111 e-mail: info.ps@georgfischer.com Internet: <http://www.gfps.com>