



PROGEF Standard Linear ball valve type 546 Pro PP-H
With fusion sockets metric

Model:

- Excellent control characteristics
- Designed for easy installation and removal
- Ball seat PTFE
- Angle of operation 90° with scale
- Integrated stainless steel mounting inserts
- Z-length, end connectors and union nuts compatible to Types 546 Linear/ 546 (Pro) and 542

Option:

- Individual configuration of the valve
- Pneumatic or electric actuators from GF
- Other materials on demand

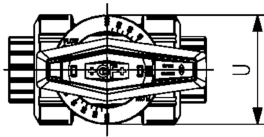

d (mm)	Size (inch)	DN (mm)	PN (bar)	kv-value ($\Delta p=1$ bar) (L/min)	EPDM Code	SP	Weight (kg)	SP	Weight (kg)
20	½	15	10	90	167 546 961	1	0.200	1	0.200
25	¾	20	10	166	167 546 962	1	0.300	1	0.300
32	1	25	10	235	167 546 963	1	0.400	1	0.400
40	1 ¼	32	10	417	167 546 964	1	0.700	1	0.700
50	1 ½	40	10	626	167 546 965	1	0.608	1	0.608
63	2	50	10	781	167 546 966	1	1.700	1	1.700

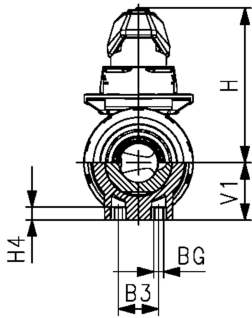

d (mm)	FKM Code	PF
20	167 546 971	2 34 539 801
25	167 546 972	2 34 539 801
32	167 546 973	2 34 539 801
40	167 546 974	2 34 539 801
50	167 546 975	2 34 539 801
63	167 546 976	2 34 539 801

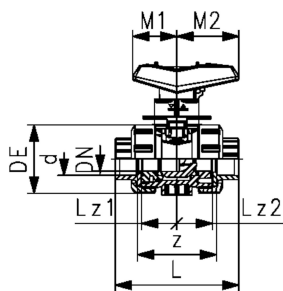

d (mm)	M1 (mm)	M2 (mm)	Lz1 (mm)	Lz2 (mm)	L (mm)	V1 (mm)	H (mm)	Hmax (mm)	DE (mm)	BG	B3 (mm)	H4 (mm)	U (mm)	z (mm)
20	35	47	28.0	28.0	95	27	72	99	50	M6	25	12	59	67
25	44	62	32.5	32.5	108	30	91	121	58	M6	25	12	68	76
32	44	62	35.5	35.5	118	36	96	132	68	M6	25	12	68	82
40	57	74	42.5	42.5	136	44	116	160	84	M8	45	15	81	97
50	57	74	44.5	44.5	147	51	122	173	97	M8	45	15	81	101
63	66	86	50.5	50.5	168	64	141	205	124	M8	45	15	91	114

The technical data are not binding. They neither constitute expressly warranted characteristics nor guaranteed properties nor a guaranteed durability. They are subject to modification. Our General Terms of Sale apply.

Georg Fischer Piping Systems Ltd, Postfach, CH-8201 Schaffhausen/Switzerland Phone +41 -(0)52-631 1111 e-mail: info.ps@georgfischer.com Internet: <http://www.gfps.com>