



PVC-U Ball valve type 546 Pro with PPA FC (Fail safe to close)
With solvent cement spigots PVC-U ISO
Without manual override
5.6 bar control pressure

Model:

- Control pressure supply through integrated NAMUR interface according VDI/VDE 3845
- Full plastic solution (actuator housing made of PP-GF)
- Visual position indicator
- Integrated stainless steel mounting inserts
- z-dimension, valve end and union nut are compatible with type 546 (1st Generation)

Option:

- Position feedback through double sensor with LED (PNP, NPN and NAMUR)
- Positioner RPC, RPC D, RPC PID
- Individual configuration of valves possible

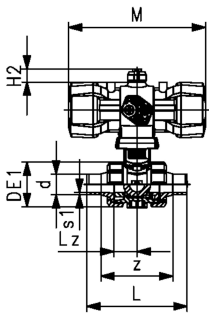
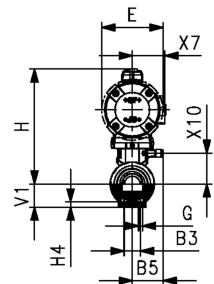
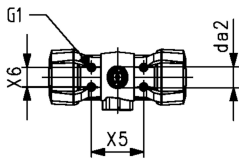

d	DN	Size	PN	kv-value	EPDM	SP	Weight	FKM	SP	Weight
(mm)	(mm)	(inch)	(bar)	($\Delta p=1$ bar)	Code		(kg)	Code		(kg)
				(l/min)						
16	10	3/8	10	70	199 250 142	1	1.159	199 250 152	1	1.159
20	15	1/2	10	185	199 250 143	1	1.159	199 250 153	1	1.159
25	20	3/4	10	350	199 250 144	1	1.276	199 250 154	1	1.276
32	25	1	10	700	199 250 145	1	1.400	199 250 155	1	1.400
40	32	1 1/4	10	1000	199 250 146	1	2.451	169 250 156	1	2.451
50	40	1 1/2	10	1600	199 250 147	1	2.773	199 250 157	1	2.773
63	50	2	10	3100	199 250 148	1	3.631	199 250 158	1	3.631
75	65	2 1/2	10	5000	199 250 149	1	7.900	199 250 159	1	7.900
90	80	3	10	7000	199 250 150	1	10.400	199 250 160	1	10.400
110	100	4	10	11000	199 250 151	1	15.700	199 250 161	1	15.700

d	Actuator	B3	B5	da2	DE1	E	G	G1	H	H2	H4	L	Lz	M	s1
(mm)		(mm)	(mm)	(mm)	(mm)	(mm)	(mm)	(mm)	(mm)	(mm)	(mm)	(mm)	(mm)	(mm)	(mm)
16	PPA08	25	16.2	33	50	74	M6	M5	155	20	12	114	28	159	3.0
20	PPA08	25	16.2	33	50	74	M6	M5	155	20	12	124	28	159	3.0
25	PPA08	25	17.5	33	58	74	M6	M5	159	20	12	144	33	159	3.0
32	PPA15	25	17.5	33	68	94	M6	M5	178	20	12	154	36	211	4.0
40	PPA15	45	23.3	33	84	94	M8	M5	184	20	15	174	43	211	4.5
50	PPA40	45	23.3	33	97	120	M8	M5	213	20	15	194	45	246	5.5
63	PPA40	45	24.3	33	124	120	M8	M5	228	20	15	224	51	246	7.0
75	PPA80	70	28.5	33	166	142	M8	M5	277	20	15	284	68	343	8.5
90	PPA80	70	28.5	33	200	142	M8	M5	289	20	15	300	71	343	10.0
110	PPA80	120	28.5	33	238	142	M12	M5	324	20	22	340	82	343	12.0

d	V1	X5	X6	X7	X10	z
(mm)	(mm)	(mm)	(mm)	(mm)	(mm)	(mm)
16	27	80	30	43	38.0	88
20	27	80	30	43	38.0	96
25	30	80	30	43	41.9	112
32	36	80	30	51	47.0	118
40	44	80	30	51	53.5	134
50	51	80	30	62	62.8	148
63	64	80	30	62	77.0	170
75	85	80	30	74	119.0	194
90	105	80	30	74	131.0	196
110	123	80	30	74	145.0	212

Data sheet



valid from: 2/8/25

The technical data are not binding. They neither constitute expressly warranted characteristics nor guaranteed properties nor a guaranteed durability. They are subject to modification. Our General Terms of Sale apply.

Georg Fischer Piping Systems Ltd, Postfach, CH-8201 Schaffhausen/Switzerland Phone +41 -(0)52-631 1111 e-mail:
info.ps@georgfischer.com Internet: <http://www.gfps.com>