

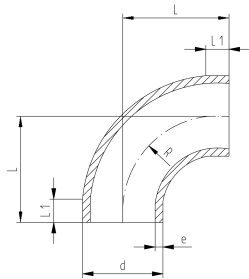

1



2



## PROGEF Standard Bend 90° SDR11/PN10

### Model:

- Material: PP-H
- Conventional butt-welding according to DVS 2207
- IR = Infrared welding compatible

d (mm)	PN (bar)	Code	Weight (kg)	L (mm)	L1 (mm)	R (mm)	e (mm)
125	10	<b>727 018 615</b>	0.818	125	28.0	116.00	11.4
140	10	<b>727 018 616</b>	1.148	140	33.0	131.00	12.7
160	10	<b>727 018 617</b>	1.699	160	33.0	151.00	14.6
180	10	<b>727 018 618</b>	2.394	180	33.0	171.00	16.4
200	10	<b>727 018 619</b>	3.264	200	33.0	190.00	18.2
225	10	<b>727 018 620</b>	4.535	220	33.0	210.00	20.5
250	10	<b>727 018 521</b>	6.351	256	48.0	232.00	22.7
280	10	<b>727 018 522</b>	9.398	286	44.5	262.00	26.8
315	10	<b>727 018 523</b>	12.959	321	48.0	297.00	28.6

The technical data are not binding. They neither constitute expressly warranted characteristics nor guaranteed properties nor a guaranteed durability. They are subject to modification. Our General Terms of Sale apply.

Georg Fischer Piping Systems Ltd, Postfach, CH-8201 Schaffhausen/Switzerland Phone +41 -(0)52-631 1111 e-mail:  
info.ps@georgfischer.com Internet: <http://www.gfps.com>