

Reducing Branch Tee 88.8° (SxSxS)

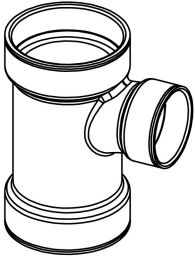

Size (inch)	DN1 (mm)	DN2 (mm)	Electrofusion Code	weight (lb)	Fast-Lock Code	SP	GJ (inch)	GK (inch)	N (inch)	GJ (mm)	GK (mm)	N (mm)
2	50	40	373 161 530	0.391	377 161 530	15	1.96	2.21	3.17	50	56	81
3	80	40	373 161 531	1.019	377 161 531	8	1.75	2.56	2.68	44	65	68
3	80	50	373 161 532	1.173	377 161 532	8	2.13	2.88	3.31	54	73	84
4	100	50	373 161 534	1.464	377 161 534	5	2.06	3.31	3.19	52	84	81
4	100	80	373 161 535	1.853	377 161 535	5	3.00	3.56	4.75	76	90	121
6	150	100	373 161 539	2.340		2	3.93	4.90	6.13	100	124	156

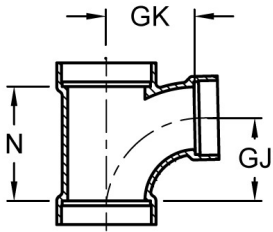

The technical data are not binding. They neither constitute expressly warranted characteristics nor guaranteed properties nor a guaranteed durability. They are subject to modification. Our General Terms of Sale apply.

Georg Fischer Piping Systems Ltd, Postfach, CH-8201 Schaffhausen/Switzerland Phone +41 -(0)52-631 1111 e-mail:
info.ps@georgfischer.com Internet: <http://www.gfps.com>