

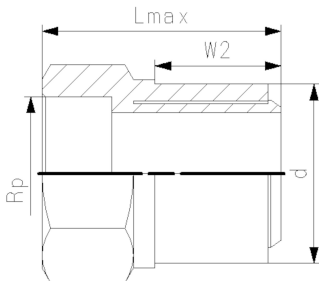

ELGEF Plus overgangsadapter PE/RVS d20-63 mm / SDR11 / binnendraad Rp

- 10 bar gas / 16 bar water
- Alleen voor ELGEF Plus moffen en fittingen
- RVS V2A (1.4305)



d (mm)	Thread Type	Inch (inch)	DN (mm)	PN (bar)	code	gewicht (kg)	Lmax (mm)	W2 (mm)
20	Rp	½	15	16	724 920 206	0,128	65	33
25	Rp	¾	20	16	724 920 207	0,181	66	33
32	Rp	1	25	16	724 920 208	0,237	71	35
40	Rp	1 ¼	32	16	724 920 209	0,373	77	39
50	Rp	1 ½	40	16	724 920 210	0,527	81	43
63	Rp	2	50	16	724 920 211	0,733	89	47

The technical data are not binding. They neither constitute expressly warranted characteristics nor guaranteed properties nor a guaranteed durability. They are subject to modification. Our General Terms of Sale apply.

Georg Fischer Piping Systems Ltd, Postfach, CH-8201 Schaffhausen/Switzerland Phone +41 -(0)52-631 1111 e-mail:
info.ps@georgfischer.com Internet: <http://www.gfps.com>