

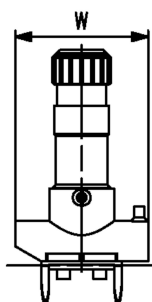

## ELGEF Plus Tapping saddle PE100 d63-400mm/ SDR11 / With 360° rotatable outlet

- 10 bar Gas / 16 bar Water
  - With integrated cutter to tap live mains under pressure
  - Complete with lower part
  - 4 mm pin connectors
  - Limited path fusion indicators
  - Long fusion outlet
  - O-ring-sealed screw cap
  - d355-400mm. Not suitable for pipes if wall thickness is larger than SDR17 pipes.
- \* Topload: delivery without lower part for assembling as Topload with tool no. 799.350.477; angle adaptor (799.350.340) for fusion cable required

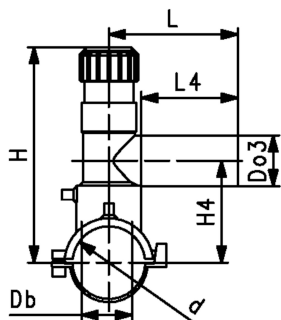

d (mm)	Do3 (mm)	DN (mm)	PN (bar)	Code	Weight (kg)
63	20	50	16	193 131 402	0.697
63	25	50	16	193 131 403	0.637
63	32	50	16	193 131 404	0.701
63	40	50	16	193 131 405	0.718
63	63	50	16	193 131 437	1.426
75	20	65	16	193 131 442	0.831
75	25	65	16	193 131 443	0.830
75	32	65	16	193 131 444	0.812
75	40	65	16	193 131 445	0.849
75	63	65	16	193 131 447	1.549
90	20	80	16	193 131 452	0.794
90	25	80	16	193 131 453	0.790
90	32	80	16	193 131 454	0.770
90	40	80	16	193 131 455	0.811
90	63	80	16	193 131 457	1.494
110	20	100	16	193 131 462	0.826
110	25	100	16	193 131 463	0.808
110	32	100	16	193 131 464	0.831
110	40	100	16	193 131 465	0.805
110	63	100	16	193 131 467	1.097
125	20	100	16	193 131 472	0.880
125	25	100	16	193 131 473	0.878
125	32	100	16	193 131 474	0.878
125	40	100	16	193 131 475	0.874
125	63	100	16	193 131 477	1.184
140	20	125	16	193 131 482	0.887
140	25	125	16	193 131 483	0.874
140	32	125	16	193 131 484	0.894
140	40	125	16	193 131 485	0.920
140	63	125	16	193 131 487	1.180
160	20	150	16	193 131 492	0.916
160	25	150	16	193 131 493	0.912
160	32	150	16	193 131 494	0.915
160	40	150	16	193 131 495	0.936
160	63	150	16	193 131 497	1.221
180	20	150	16	193 131 502	0.994
180	25	150	16	193 131 503	1.001
180	32	150	16	193 131 504	0.957
180	40	150	16	193 131 505	1.007
180	63	150	16	193 131 507	1.587
200	20	200	16	193 131 512	1.015
200	25	200	16	193 131 513	1.015
200	32	200	16	193 131 514	0.985
200	40	200	16	193 131 515	1.024
200	63	200	16	193 131 517	1.290
225	20	200	16	193 131 522	1.016

# Data sheet

valid from: 6/20/25

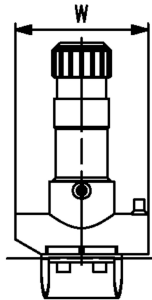
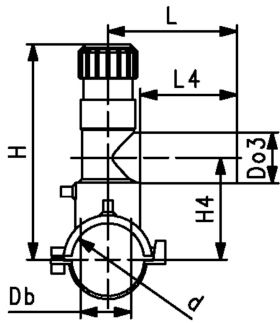

	d (mm)	Do3 (mm)	DN (mm)	PN (bar)	Code	Weight (kg)
	225	25	200	16	<b>193 131 523</b>	1.025
	225	32	200	16	<b>193 131 524</b>	1.019
	225	40	200	16	<b>193 131 525</b>	1.029
	225	63	200	16	<b>193 131 527</b>	1.738
	250	20	250	16	<b>193 131 532</b>	1.025
	250	25	250	16	<b>193 131 533</b>	1.026
	250	32	250	16	<b>193 131 534</b>	0.996
	250	63	250	16	<b>193 131 537</b>	1.733
	250	40	250	16	<b>193 131 535</b>	1.008
	280	63	250	16	<b>193 131 548</b>	1.478
	315	63	300	16	<b>193 131 558</b>	1.481
Topload	355	63	350	16	<b>193 131 557</b>	1.481
Topload	400	63	400	16	<b>193 131 577</b>	1.473

	d (mm)	Do3 (mm)	L (mm)	L4 (mm)	Db (mm)	W (mm)	H (mm)	H4 (mm)	Suitable for
	63	20	130	71	32	164	186	108	SDR Pipe 9-11
	63	25	130	71	32	164	186	108	SDR Pipe 9-11
	63	32	130	76	32	164	186	108	SDR Pipe 9-11
	63	40	137	81	32	164	186	108	SDR Pipe 9-11
	63	63	160	100	32	164	134	112	SDR Pipe 9-11
	75	20	130	71	32	164	191	113	SDR Pipe 9-11
	75	25	130	71	32	164	191	113	SDR Pipe 9-11
	75	32	130	76	32	164	191	113	SDR Pipe 9-11
	75	40	137	81	32	164	191	113	SDR Pipe 9-11
	75	63	160	100	32	164	240	118	SDR Pipe 9-11
	90	20	130	71	32	164	199	121	SDR Pipe 9-11
	90	25	130	71	32	164	199	121	SDR Pipe 9-11
	90	32	130	76	32	164	199	121	SDR Pipe 9-11
	90	40	137	81	32	164	199	121	SDR Pipe 9-11
	90	63	160	100	35	164	248	126	SDR Pipe 9-11
	110	20	130	71	32	164	209	131	SDR Pipe 9-17.6
	110	25	130	71	32	164	209	131	SDR Pipe 9-17.6
	110	32	130	76	32	164	209	131	SDR Pipe 9-17.6
	110	40	137	81	32	164	209	131	SDR Pipe 9-17.6
	110	63	160	100	35	164	258	136	SDR Pipe 9-17.6
	125	20	130	71	32	164	216	138	SDR Pipe 9-17.6
	125	25	130	71	32	164	216	138	SDR Pipe 9-17.6
	125	32	130	76	32	164	216	138	SDR Pipe 9-17.6
	125	40	137	81	32	164	216	138	SDR Pipe 9-17.6
	125	63	160	100	35	164	265	143	SDR Pipe 9-17.6
	140	20	130	71	32	164	233	146	SDR Pipe 9-17.6
	140	25	130	71	32	164	233	146	SDR Pipe 9-17.6
	140	32	130	76	32	164	233	146	SDR Pipe 9-17.6
	140	40	137	81	32	164	233	146	SDR Pipe 9-17.6
	140	63	160	100	35	164	273	151	SDR Pipe 9-17.6
	160	20	130	71	32	164	243	156	SDR Pipe 9-17.6
	160	25	130	71	32	164	243	156	SDR Pipe 9-17.6
	160	32	130	76	32	164	243	156	SDR Pipe 9-17.6

# Data sheet

valid from: 6/20/25

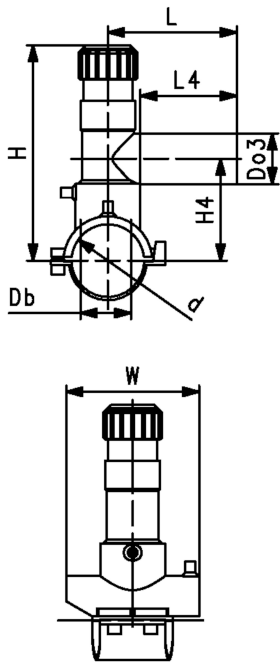

	d (mm)	Do3 (mm)	L (mm)	L4 (mm)	Db (mm)	W (mm)	H (mm)	H4 (mm)	Suitable for
	160	40	137	81	32	164	243	156	SDR Pipe 9-17.6
	160	63	160	100	35	164	283	161	SDR Pipe 9-17.6
	180	20	130	71	32	164	244	166	SDR Pipe 9-26
	180	25	130	71	32	164	244	166	SDR Pipe 9-26
	180	32	130	76	32	164	244	166	SDR Pipe 9-26
	180	40	137	81	32	164	244	166	SDR Pipe 9-26
	180	63	160	100	35	164	293	171	SDR Pipe 9-26
	200	20	130	71	32	164	254	176	SDR Pipe 9-26
	200	25	130	71	32	164	254	176	SDR Pipe 9-26
	200	32	130	76	32	164	254	176	SDR Pipe 9-26
	200	40	137	81	32	164	254	176	SDR Pipe 9-26
	200	63	160	100	35	164	303	181	SDR Pipe 9-26
	225	20	130	71	32	164	266	188	SDR Pipe 11-26
	225	25	130	71	32	164	266	188	SDR Pipe 11-26
	225	32	130	76	32	164	266	188	SDR Pipe 11-26
	225	40	137	81	32	164	266	188	SDR Pipe 11-26
	225	63	160	100	35	164	315	193	SDR Pipe 11-26
	250	20	130	76	32	164	279	201	SDR Pipe 11-26
	250	25	130	76	32	164	279	201	SDR Pipe 11-26
	250	32	130	76	32	164	279	201	SDR Pipe 11-26
	250	63	160	100	35	164	328	206	SDR Pipe 11-26
	250	40	137	81	32	164	279	201	SDR Pipe 11-26
	280	63	160	100	35	164	343	206	SDR Pipe 11-26
	315	63	160	100	35	164	381	206	SDR Pipe 11-33
Topload	355	63	160	100	35	165	381	206	SDR Pipe 17-33
Topload	400	63	160	100	35	165	403	206	SDR Pipe 17-33

The technical data are not binding. They neither constitute expressly warranted characteristics nor guaranteed properties nor a guaranteed durability. They are subject to modification. Our General Terms of Sale apply.

Georg Fischer Piping Systems Ltd, Postfach, CH-8201 Schaffhausen/Switzerland Phone +41 -(0)52-631 1111 e-mail: info.ps@georgfischer.com Internet: <http://www.gfps.com>