

Diaphragm valve type 517 PVC-C
With backing flanges PP-V metric/BS

Model:

- Double flow rate compared to predecessor
- One housing nut replaces four screws
- Handwheel with built-in locking mechanism
- Flat sealing faces
- Overall length EN 558
- Connecting dimension: ISO 7005 PN 10, EN 1092 PN 10, DIN 2501 PN 10, BS 4504 PN 10

Option:

- Individual configuration of the valve
- Self adjusting multifunctional module with integrated limit switches

* O-Ring material: FKM

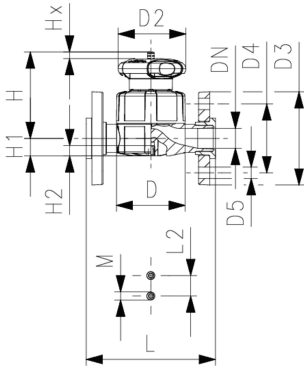

| d (mm) | DN (mm) | Size (inch) | PN (bar) | kv-value ($\Delta p=1$ bar) (l/min) | EPDM Code | SP | Weight (kg) | PTFE/ EPDM* Code | SP | Weight (kg) |
|-----------|------------|----------------|-------------|--|--------------------|----|----------------|------------------------|----|----------------|
| 20 | 15 | ½ | 10 | 125 | 163 517 112 | 1 | 0.447 | 163 517 132 | 1 | 0.529 |
| 25 | 20 | ¾ | 10 | 271 | 163 517 113 | 1 | 0.696 | 163 517 133 | 1 | 0.696 |
| 32 | 25 | 1 | 10 | 481 | 163 517 114 | 1 | 1.388 | 163 517 134 | 1 | 0.952 |
| 40 | 32 | 1 ¼ | 10 | 759 | 163 517 115 | 1 | 1.797 | 163 517 135 | 1 | 1.818 |
| 50 | 40 | 1 ½ | 10 | 1263 | 163 517 116 | 1 | 2.854 | 163 517 136 | 1 | 2.142 |
| 63 | 50 | 2 | 10 | 1728 | 163 517 117 | 1 | 3.318 | 163 517 137 | 1 | 3.115 |

| d (mm) | D (mm) | D2 (mm) | D3 (mm) | D4 (mm) | D5 (mm) | H (mm) | H1 (mm) | H2 (mm) | L (mm) | L2 (mm) | M | Lift = Hx (mm) | closest inch (inch) |
|-----------|-----------|------------|------------|------------|------------|-----------|------------|------------|-----------|------------|----|----------------------|---------------------------|
| 20 | 65 | 65 | 95 | 65 | 14 | 73 | 14 | 12 | 130 | 25 | M6 | 7 | ½ |
| 25 | 80 | 65 | 105 | 75 | 14 | 81 | 18 | 12 | 150 | 25 | M6 | 10 | ¾ |
| 32 | 88 | 87 | 115 | 85 | 14 | 107 | 22 | 12 | 160 | 25 | M6 | 13 | 1 |
| 40 | 101 | 87 | 140 | 100 | 18 | 115 | 26 | 15 | 180 | 45 | M8 | 15 | 1 ¼ |
| 50 | 117 | 135 | 150 | 110 | 18 | 148 | 32 | 15 | 200 | 45 | M8 | 19 | 1 ½ |
| 63 | 144 | 135 | 165 | 125 | 18 | 166 | 39 | 15 | 230 | 45 | M8 | 25 | 2 |

The technical data are not binding. They neither constitute expressly warranted characteristics nor guaranteed properties nor a guaranteed durability. They are subject to modification. Our General Terms of Sale apply.

Georg Fischer Piping Systems Ltd, Postfach, CH-8201 Schaffhausen/Switzerland Phone +41 -(0)52-631 1111 e-mail: info.ps@georgfischer.com Internet: <http://www.gfps.com>