

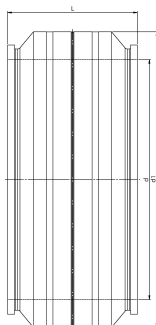

ELGEF Plus Electrofusion coupler PE100 d900mm / SDR11

- 16 bar Water
- Only for water applications
- 4mm pin connectors

d (mm)	SDR	PN (bar)	DN (mm)	Code	Weight (kg)	d1 (mm)	L (mm)	SDR pipe
900	11	16	900	753 911 652	137.930	1110	550	9-17.6



The technical data are not binding. They neither constitute expressly warranted characteristics nor guaranteed properties nor a guaranteed durability. They are subject to modification. Our General Terms of Sale apply.

Georg Fischer Piping Systems Ltd, Postfach, CH-8201 Schaffhausen/Switzerland

Phone +41 -(0)52-631 1111

e-mail: info.ps@georgfischer.com

Internet: <http://www.gfps.com>