



**PVC-U Ball valve type 127**  
**100-230V**  
**With manual emergency override**  
**With backing flanges PVC-U ASME**

**Model:**

- IP68 Rating
- Factory set control range 90°<
- Heating element, position feedback (Open/Close/ Middle)
- Integrated stainless steel mounting inserts

**Option:**

- Other valve and actuator configurations available
- Optional accessories: Fail-safe return unit

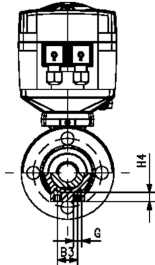

d	DN	Size	PN	kv-value	EPDM	Weight	FKM	Weight
(mm)	(mm)	(inch)	(bar)	( $\Delta p=1$ bar)	Code	(kg)	Code	(kg)
				(L/min)				
20	15	1/2	10	185	<b>199 127 283</b>	2.300	<b>199 127 293</b>	2.300
25	20	3/4	10	350	<b>199 127 284</b>	2.500	<b>199 127 294</b>	2.500
32	25	1	10	700	<b>199 127 285</b>	2.700	<b>199 127 295</b>	2.700
40	32	1 1/4	10	1000	<b>199 127 286</b>	3.200	<b>199 127 296</b>	3.200
50	40	1 1/2	10	1600	<b>199 127 287</b>	3.700	<b>199 127 297</b>	3.700
63	50	2	10	3100	<b>199 127 288</b>	4.800	<b>199 127 298</b>	4.800

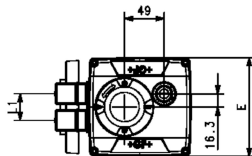

d	Actuator	b1	B3	D1	DE1	E	G	H	H1	H4	k1	L	L1	Lz	M
(mm)		(mm)	(mm)	(mm)	(mm)	(mm)	(mm)	(mm)	(mm)	(mm)	(mm)	(mm)	(mm)	(mm)	(mm)
20	EA15	12	25	95	50	122	M6	197	27	12	60	130	33	28	161
25	EA15	12	25	105	58	122	M6	201	30	12	70	150	33	33	161
32	EA15	14	25	115	68	122	M6	207	36	12	79	160	33	36	161
40	EA15	16	45	140	84	122	M8	213	44	15	89	180	33	43	161
50	EA15	16	45	150	97	122	M8	219	51	15	98	200	33	45	161
63	EA15	18	45	165	124	122	M8	234	64	15	121	230	33	51	161

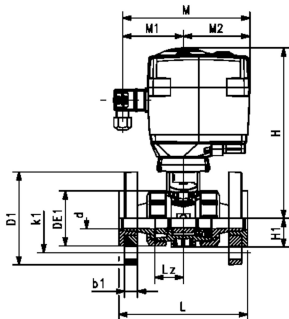

d	M1	M2
(mm)	(mm)	(mm)
20	77	83
25	77	83
32	77	83
40	77	83
50	77	83
63	77	83

The technical data are not binding. They neither constitute expressly warranted characteristics nor guaranteed properties nor a guaranteed durability. They are subject to modification. Our General Terms of Sale apply.

Georg Fischer Piping Systems Ltd, Postfach, CH-8201 Schaffhausen/Switzerland Phone +41 -(0)52-631 1111 e-mail: info.ps@georgfischer.com Internet: <http://www.gfps.com>