



Lug-Style, end installation butterfly valve metal type 038
Bare Shaft
Flange standard metric - PN10
Disc: Alu-Bronze

Model:

- Lug Style
- Body GGG40 (A 395 / A395 M-99, EN-JIS 1020 EN1563) Rilsan® coating
- Installation length: EN 558 row 20
- Interface according to DIN EN ISO 5211
- Pressure range: 16 bar (DN 50-300)
- Axis DN50 - DN300: Single-piece axis with square profile, material stainless steel DIN Norm 1.4021
- Flange connection: DN50 - DN300: PN6, PN10, ANSI 125/150 Lbs., BS 10-D/E

Option:

- Available with handlever, handwheel, electric or pneumatic actuator
- Other liner material on request

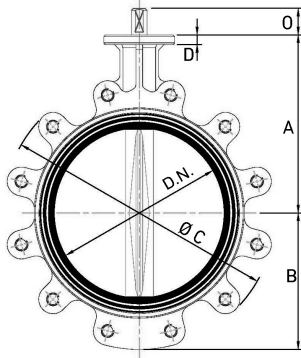

d (mm)	DN (mm)	Size (inch)	PN (bar)	kv-value ($\Delta p=1$ bar) (L/min)	Liner: EPDM Code	PF	SP	Weight (kg)	Liner: FKM Code
63	50	2	16	3140	198 151 049	3 39 226 998		3.20	198 151 058
75	65	2 ½	16	4570	198 151 050	3 39 226 998		4.40	198 151 059
90	80	3	16	7140	198 151 051	3 39 226 998		6.02	198 151 060
110	100	4	16	11710	198 151 052	3 39 226 998		8.10	198 151 061
140	125	5	16	18570	198 151 053	3 39 226 998		10.50	198 151 062
160	150	6	16	27130	198 151 054	3 39 226 998		11.66	198 151 063
225	200	8	16	47130	198 151 055	3 39 226 998		17.42	198 151 064
280	250	10	16	77110	198 151 056	3 39 226 998		32.50	
315	300	12	16	114240	198 151 057	3 39 226 998		33.00	198 151 066

d (mm)	D3 (mm)	D4 (mm)	D5 (mm)	D6 (mm)	H (mm)	H1 (mm)	H2 (mm)	Cv value ($\Delta p=1$ psi) (L/min)	L (mm)	Q (mm)	SW (mm)	AL
63	9	14	90	70	229	13	26	220	43	32	11	4 F-07
75	9	14	90	70	251	13	26	320	46	51	11	4 F-07
90	9	14	90	70	266	13	26	500	46	69	11	4 F-07
110	9	18	90	70	305	16	30	820	52	89	14	4 F-07
140	9	18	90	70	333	16	30	1300	56	115	14	4 F-07
160	9	22	90	70	358	17	33	1900	56	143	17	4 F-07
225	9	22	90	70	427	17	33	3330	60	194	17	4 F-07
280	11	28	125	102	525	17	47	5400	68	243	22	4 F-10
315	11	28	125	102	603	17	47	8000	78	293	22	4 F-10

The technical data are not binding. They neither constitute expressly warranted characteristics nor guaranteed properties nor a guaranteed durability. They are subject to modification. Our General Terms of Sale apply.

Georg Fischer Piping Systems Ltd, Postfach, CH-8201 Schaffhausen/Switzerland Phone +41 -(0)52-631 1111 e-mail: info.ps@georgfischer.com Internet: <http://www.gfps.com>