

**Diaphragm valve DIASTAR Ten PVC-U
DA (Double acting)
Unions with solvent cement sockets ASTM**

Model:

- Double flow rate compared to predecessor
- One housing nut replaces four screws
- Rotating air connection at 90° intervals
- For easy installation and removal
- Short overall length

Option:

- Individual configuration of the valve
- Comprehensive range of accessories available
- PN16 available as a configuration

* PN: PTFE

Working Pressure: **one side**

* O-Ring material: FKM

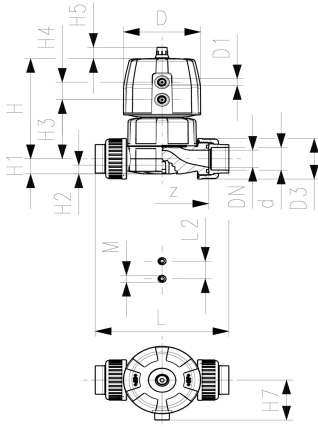

d (mm)	DN (mm)	Size (inch)	PN (bar)	kv-value ($\Delta p=1$ bar) (l/min)	PN* (bar)	EPDM Code	SP	Weight (kg)
20	15	½	10	125	10*	161 654 612	1	0.507
25	20	¾	10	271	10*	161 654 613	1	0.913
32	25	1	10	481	10*	161 654 614	1	1.158
40	32	1 ¼	10	759	10*	161 654 615	1	1.796
50	40	1 ½	10	1263	10*	161 654 616	1	2.990
63	50	2	10	1728	10*	161 654 617	1	3.875

FKM Code	PTFE/ EPDM* Code	SP	Weight (kg)
161 654 662	161 654 632	1	0.536
161 654 663	161 654 633	1	0.924
161 654 664	161 654 634	1	1.161
161 654 665	161 654 635	1	1.816
161 654 666	161 654 636	1	3.020
161 654 667	161 654 637	1	3.903

D (mm)	D1_G (inch)	H (mm)	H1 (mm)	H2 (mm)	H3 (mm)	H4 (mm)	H5 (mm)	H7 (mm)	L (mm)	L2 (mm)	M	z (mm)	Lift = Hx (mm)
68	⅝	101	14	12	60	24	16	43	141	25	M6	96	7
96	⅝	132	18	12	73	25	16	57	165	25	M6	114	10
96	⅝	143	22	12	84	25	16	57	179	25	M6	122	13
120	⅝	173	26	15	99	26	26	69	204	45	M8	140	15
150	¾	214	32	15	119	36	26	88	230	45	M8	160	19
150	¾	226	39	15	132	36	26	88	268	45	M8	190	23

The technical data are not binding. They neither constitute expressly warranted characteristics nor guaranteed properties nor a guaranteed durability. They are subject to modification. Our General Terms of Sale apply.

Georg Fischer Piping Systems Ltd, Postfach, CH-8201 Schaffhausen/Switzerland Phone +41 -(0)52-631 1111 e-mail: info.ps@georgfischer.com Internet: <http://www.gfps.com>