

PROGEF Standard Ball Valve type 546 Pro
Silicone free
With backing flanges PP-St ANSI with PP-H

Model:

- Lockable lever as standard
- Ball seat PTFE
- Integrated stainless steel mounting inserts
- Z-dimension, valve end and union nut **are compatible** with type 546 (1st Generation)

Option:

- Interface module for position feedback sensor with LED (PNP, NPN and NAMUR)
- Manual spring return lever "Dead man" (DN10-25)
- Pneumatic or electric actuators from GF
- Individual configuration of the valve possible

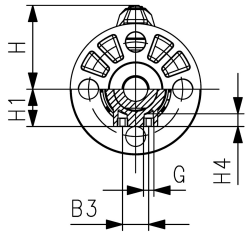

d (mm)	DN (mm)	Size (inch)	PN (bar)	kv-value ($\Delta p=1$ bar) (L/min)	EPDM Code	SP Weight (kg)	FKM Code	SP Weight (kg)		
75	65	2 1/2	10	5000	167 546 888	1	4.300	167 546 898	1	4.300
90	80	3	10	7000	167 546 889	1	6.400	167 546 899	1	6.400
110	100	4	10	11000	167 546 890	1	10.000	167 546 900	1	10.000

d (mm)	b1 (mm)	B3 (mm)	D1 (mm)	DE1 (mm)	G (inch)	H (mm)	H1 (mm)	H4 (mm)	k1 (mm)	L (mm)	Lz (mm)	M (mm)	M1 (mm)	M2 (mm)
75	18	70	166	166	M8	169	85	15	140	290	68	270	64	205
90	20	70	200	200	M8	180	105	15	152	310	71	270	64	205
110	20	120	238	238	M12	194	123	22	190	350	82	326	71	255

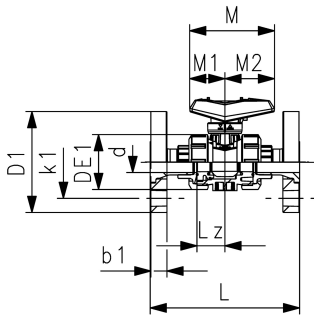

The technical data are not binding. They neither constitute expressly warranted characteristics nor guaranteed properties nor a guaranteed durability. They are subject to modification. Our General Terms of Sale apply.

Georg Fischer Piping Systems Ltd, Postfach, CH-8201 Schaffhausen/Switzerland Phone +41 -(0)52-631 1111 e-mail:
 info.ps@georgfischer.com Internet: <http://www.gfps.com>