



**PVC-U Ball valve type 546 Pro with PPA
FC (Fail Safe to Close)
With backing flanges PVC-U ASME
With manual override**

Model:

- Control pressure supply through integrated NAMUR interface according VDI/VDE 3845
- Full plastic solution (actuator housing made of PP-GF)
- Visual position indicator
- Integrated stainless steel mounting inserts
- z-dimension, valve end and union nut are compatible with type 546 (1st Generation)

Option:

- Position feedback through double sensor with LED (PNP, NPN and NAMUR)
- Positioner RPC, RPC D, RPC PID
- Individual configuration of valves possible

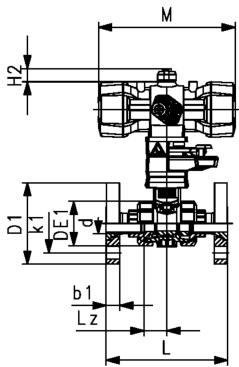
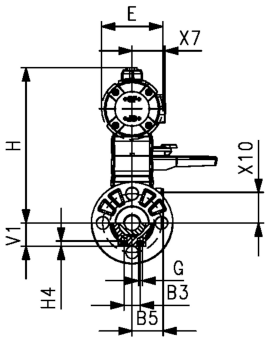
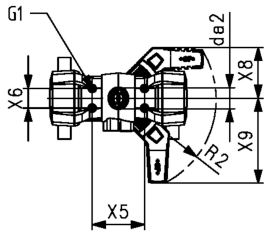

d (mm)	DN (mm)	Size (inch)	PN (bar)	kv-value ($\Delta p=1$ bar) (L/min)	EPDM Code	SP	Weight (kg)	FKM Code	SP	Weight (kg)
20	15	½	10	185	199 253 123	1	1.700	199 253 133	1	1.700
25	20	¾	10	350	199 253 124	1	1.900	199 253 134	1	1.900
32	25	1	10	700	199 253 125	1	2.100	199 253 135	1	1.788
40	32	1 ¼	10	1000	199 253 126	1	3.400	199 253 136	1	3.400
50	40	1 ½	10	1600	199 253 127	1	3.800	199 253 137	1	3.800
63	50	2	10	3100	199 253 128	1	4.900	199 253 138	1	4.900

d (mm)	Actuator	b1 (mm)	B3 (mm)	B5 (mm)	D1 (mm)	da2 (mm)	DE1 (mm)	E (mm)	G (mm)	G1 (mm)	H (mm)	H2 (mm)	H4 (mm)	k1 (mm)	L (mm)
20	PPA08	12	25	16.2	95	33	50	74	M6	M5	215	20	12	60	130
25	PPA08	12	25	17.5	105	33	58	74	M6	M5	219	20	12	70	150
32	PPA15	14	25	17.5	115	33	68	74	M6	M5	238	20	12	79	160
40	PPA15	16	45	23.3	140	33	84	94	M8	M5	244	20	15	89	180
50	PPA40	16	45	23.3	150	33	97	120	M8	M5	273	20	15	98	200
63	PPA40	18	45	24.3	165	33	124	120	M8	M5	288	20	15	121	230

d (mm)	Lz (mm)	M (mm)	R2	V1 (mm)	X5 (mm)	X6 (mm)	X7 (mm)	X8 (mm)	X9 (mm)	X10 (mm)
20	28	159	R150	27	80	30	43	78	132	38.00
25	33	159	R150	30	80	30	43	78	132	41.90
32	36	211	R150	36	80	30	51	78	132	47.00
40	43	211	R150	44	80	30	51	78	132	53.50
50	45	246	R150	51	80	30	62	78	132	62.75
63	51	246	R150	64	80	30	62	78	132	77.00

The technical data are not binding. They neither constitute expressly warranted characteristics nor guaranteed properties nor a guaranteed durability. They are subject to modification. Our General Terms of Sale apply.

Georg Fischer Piping Systems Ltd, Postfach, CH-8201 Schaffhausen/Switzerland Phone +41 -(0)52-631 1111 e-mail: info.ps@georgfischer.com Internet: <http://www.gfps.com>