



**PVC-U Ball valve type 546 Pro with PPA  
FO (Fail Safe to Open)  
With fixed flanges PVC-U JIS  
With manual override  
4.2 bar control pressure**

**Model:**

- Control pressure supply through integrated NAMUR interface according VDI/VDE 3845
- Full plastic solution (actuator housing made of PP-GF)
- Visual position indicator
- Integrated stainless steel mounting inserts
- z-dimension, valve end and union nut are compatible with type 546 (1st Generation)

**Option:**

- Position feedback through double sensor with LED (PNP, NPN and NAMUR)
- Positioner RPC, RPC D, RPC PID
- Individual configuration of valves possible

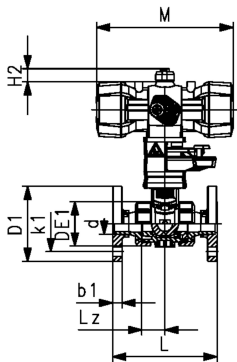
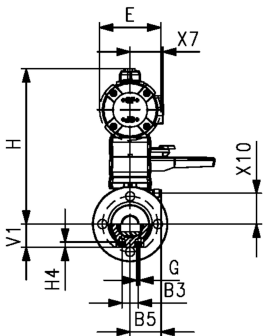
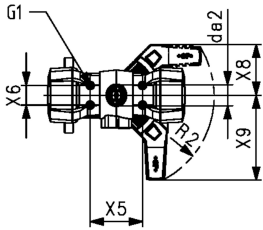

d	DN	PN	Size	kv-value	EPDM	SP	Weight	FKM	SP
(mm)	(mm)	(bar)	(inch)	( $\Delta p=1$ bar)	Code		(kg)	Code	Weight
				(l/min)					(kg)
20	15	10	½	185	199 255 143	1	1.700	199 255 153	1 1.700
25	25	10	1	700	199 255 145	1	2.100	199 255 155	1 2.100
32	20	10	¾	350	199 255 144	1	1.900	199 255 154	1 1.900
40	32	10	1 ¼	1000	199 255 146	1	3.400	199 255 156	1 3.400
50	40	10	1 ½	1600	199 255 147	1	3.800	199 255 157	1 3.800
63	50	10	2	3100	199 255 148	1	4.900	199 255 158	1 4.900

d	Actuator	b1	B3	B5	D1	da2	DE1	E	G	G1	H	H2	H4	k1	L
(mm)		(mm)	(mm)	(mm)	(mm)	(mm)	(mm)	(mm)	(mm)	(mm)	(mm)	(mm)	(mm)	(mm)	(mm)
20	PPA15	12	25	16.2	95	33	50	74	M6	M5	215	20	12	70	130
25	PPA15	14	25	17.5	105	33	58	74	M6	M5	219	20	12	75	150
32	PPA15	14	25	17.5	115	33	68	94	M8	M5	238	20	12	90	160
40	PPA40	16	45	23.3	140	33	84	94	M8	M5	244	20	15	100	180
50	PPA40	16	45	23.3	150	33	97	120	M8	M5	273	20	15	105	200
63	PPA40	18	45	24.3	165	33	124	120	M8	M5	288	20	15	120	230

d	Lz	M	R2	V1	X5	X6	X7	X8	X9	X10
(mm)	(mm)	(mm)		(mm)	(mm)	(mm)	(mm)	(mm)	(mm)	(mm)
20	28	159	R150	27	80	30	43	78	132	38.00
25	33	159	R150	30	80	30	43	78	132	41.90
32	36	211	R150	36	80	30	51	78	132	47.00
40	43	211	R150	44	80	30	51	78	132	53.50
50	45	246	R150	51	80	30	62	78	132	62.75
63	51	246	R150	64	80	30	62	78	132	77.00

The technical data are not binding. They neither constitute expressly warranted characteristics nor guaranteed properties nor a guaranteed durability. They are subject to modification. Our General Terms of Sale apply.

Georg Fischer Piping Systems Ltd, Postfach, CH-8201 Schaffhausen/Switzerland Phone +41 -(0)52-631 1111 e-mail: info.ps@georgfischer.com Internet: <http://www.gfps.com>