



**PVC-U Ball valve type 546 Pro with PPA  
DA (Double Acting)  
With backing flanges PVC-U ASME  
With manual override**

**Model:**

- Control pressure supply through integrated NAMUR interface according VDI/VDE 3845
- Full plastic solution (actuator housing made of PP-GF)
- Visual position indicator
- Integrated stainless steel mounting inserts
- z-dimension, valve end and union nut are compatible with type 546 (1st Generation)

**Option:**

- Position feedback through double sensor with LED (PNP, NPN and NAMUR)
- Positioner RPC, RPC D, RPC PID
- Individual configuration of valves possible

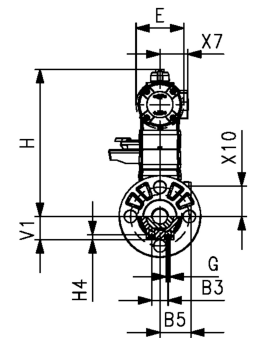
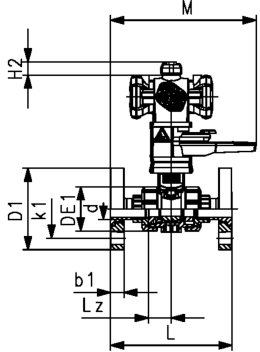
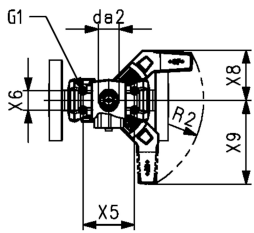

d (mm)	DN (mm)	Size (inch)	PN (bar)	kv-value ( $\Delta p=1$ bar) (L/min)	EPDM Code	SP	Weight (kg)	FKM Code	SP	Weight (kg)
20	15	½	10	185	199 253 163	1	1.700	199 253 173	1	1.700
25	20	¾	10	350	199 253 164	1	1.900	199 253 174	1	1.900
32	25	1	10	700	199 253 165	1	2.100	199 253 175	1	2.100
40	32	1 ¼	10	1000	199 253 166	1	3.400	199 253 176	1	3.400
50	40	1 ½	10	1600	199 253 167	1	3.800	199 253 177	1	3.800
63	50	2	10	3100	199 253 168	1	4.900	199 253 178	1	4.900

d (mm)	Actuator	b1 (mm)	B3 (mm)	B5 (mm)	D1 (mm)	da2 (mm)	DE1 (mm)	E (mm)	G (mm)	G1 (mm)	H (mm)	H2 (mm)	H4 (mm)	k1 (mm)	L (mm)
20	PPA08	12	25	16.2	95	33	50	74	M6	M5	215	20	12	60	130
25	PPA08	12	25	17.5	105	33	58	74	M6	M5	219	20	12	70	150
32	PPA08	14	25	17.5	115	33	68	74	M6	M5	238	20	12	79	160
40	PPA15	16	45	23.3	140	33	84	94	M8	M5	244	20	15	89	180
50	PPA15	16	45	23.3	150	33	97	120	M8	M5	273	20	15	98	200
63	PPA40	18	45	24.3	165	33	124	120	M8	M5	288	20	15	121	230

d (mm)	Lz (mm)	M (mm)	R2	V1 (mm)	X5 (mm)	X6 (mm)	X7 (mm)	X8 (mm)	X9 (mm)	X10 (mm)
20	28	128	R150	27	80	30	43	78	132	38.00
25	33	128	R150	30	80	30	43	78	132	41.90
32	36	128	R150	36	80	30	51	78	132	47.00
40	43	159	R150	44	80	30	51	78	132	53.50
50	45	159	R150	51	80	30	62	78	132	62.75
63	51	184	R150	64	80	30	62	78	132	77.00

The technical data are not binding. They neither constitute expressly warranted characteristics nor guaranteed properties nor a guaranteed durability. They are subject to modification. Our General Terms of Sale apply.

Georg Fischer Piping Systems Ltd, Postfach, CH-8201 Schaffhausen/Switzerland Phone +41 -(0)52-631 1111 e-mail: info.ps@georgfischer.com Internet: <http://www.gfps.com>