

## Monoline tapping saddle with bottom belt - Cutter Size – 8 mm

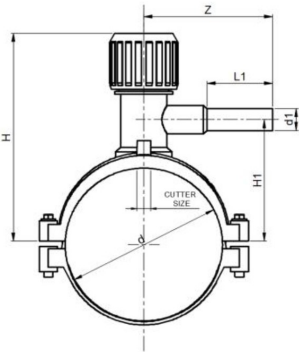

- PE 100 SDR 11 (ISO S5)
- 10 bar Gas / 16 bar Water
- With an in-built cutter to tap live mains under pressure
- With integral pipe fixation
- Limited path fusion indicators
- Approval: DVGW / WRAS



d (mm)	d1 (mm)	SS304 Code	Weight (kg)	GP	Brass Code	H (mm)	H1 (mm)	L (mm)	L1 (mm)	Z (mm)
32	20		0.164	10	<b>193 281 459</b>	94	38	100	75	89
50	20	<b>300 210 620</b>	0.423	30		138	65	145	53	114
63	20	<b>300 210 625</b>	0.479	25		145	71	175	53	114
75	20	<b>300 210 633</b>	0.481	22		171	81	175	64	121
90	20	<b>300 210 641</b>	0.583	20		189	93	175	64	121
110	20	<b>300 210 649</b>	0.625			199	103	175	64	121
125	20	<b>300 210 657</b>	0.653	15		207	111	175	64	121
140	20	<b>300 210 971</b>	0.713	12		216	120	175	64	121
160	20	<b>300 210 665</b>	0.783	10		224	128	175	64	121
180	20	<b>300 210 673</b>	0.823	10		234	138	175	64	121
200	20	<b>300 210 681</b>	0.895	10		244	148	175	64	121
225	20	<b>300 210 689</b>	0.558			257	161	175	59	121

The technical data are not binding. They neither constitute expressly warranted characteristics nor guaranteed properties nor a guaranteed durability. They are subject to modification. Our General Terms of Sale apply.

Georg Fischer Piping Systems Ltd, Postfach, CH-8201 Schaffhausen/Switzerland Phone +41 -(0)52-631 1111 e-mail: info.ps@georgfischer.com Internet: <http://www.gfps.com>