

## SYGEF Standard check valve type 562 With fixed flanges metric

### Model:

- Material: PVDF
- For horizontal or vertical installation
- 100% leak-tight in the closed/idle state, independent of installation orientation and without hydrostatic head
- Spring loaded, spring made of stainless steel (1.4310)
- Spring available in other materials, see spare parts
- Designed for easy installation and removal
- Vibration free even at high flow velocity
- Flow-optimized return cone, double guided
- Compact installation length, same as ball valve type 546
- Installation length according to EN 558-1
- Z-length, end connectors and union nuts **not** compatible with type 360
- Connecting dimension: ISO 7005 PN10, EN 1092 PN10, DIN 2501 PN10

Warning: please make sure the diameter is not reduced through welding beads (Danger of turbulences)

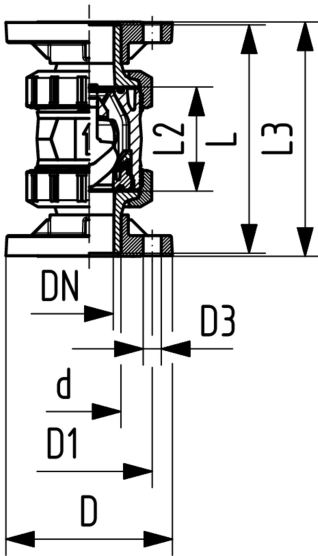

d (mm)	DN (mm)	PN (bar)	kv-value ( $\Delta p=1$ bar) (L/min)	FKM Code	SP	Weight (kg)
20	15	16	180	<b>175 562 192</b>	1	0.420
25	20	16	380	<b>175 562 193</b>	1	0.700
32	25	16	460	<b>175 562 194</b>	1	0.860
40	32	16	850	<b>175 562 195</b>	1	1.430
50	40	16	1080	<b>175 562 196</b>	1	1.940
63	50	16	1670	<b>175 562 197</b>	1	3.160

d (mm)	D (mm)	D1 (mm)	D3 (mm)	L (mm)	L2 (mm)	L3 (mm)	Size (inch)
20	93	65	14	120	56	130	½
25	103	75	14	140	65	150	¾
32	115	85	14	150	71	160	1
40	137	100	18	170	85	180	1 ¼
50	147	110	18	190	89	200	1 ½
63	162	125	18	220	101	230	2

The technical data are not binding. They neither constitute expressly warranted characteristics nor guaranteed properties nor a guaranteed durability. They are subject to modification. Our General Terms of Sale apply.

Georg Fischer Piping Systems Ltd, Postfach, CH-8201 Schaffhausen/Switzerland Phone +41 -(0)52-631 1111 e-mail: info.ps@georgfischer.com Internet: <http://www.gfps.com>