

**PROGEF Standard Diaphragm valve DIASTAR Ten FC (Fail safe to close)**  
**With socket fusion spigots metric**

**Model:**

- Material: PP-H
- Double flow rate compared to predecessor
- One housing nut replaces four screws
- Rotating air connection at 90° intervals
- Overall length EN 558

**Option:**

- Individual configuration of the valve
- Comprehensive range of accessories available

\* PN: PTFE

Working Pressure: **one side**

\* O-Ring material: FKM

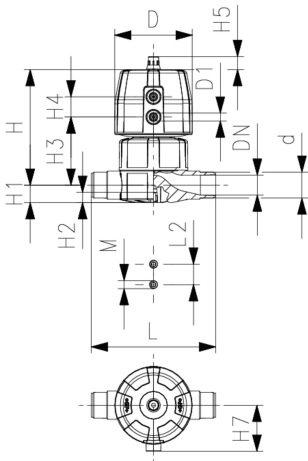

d (mm)	DN (mm)	Size (inch)	PN (bar)	PN* (bar)	kv-value ( $\Delta p=1$ bar) (l/min)	EPDM Code	Weight (kg)	PTFE/ EPDM* Code	Weight (kg)
20	15	½	10	10*	125	<b>167 625 012</b>	0.461	<b>167 625 032</b>	0.502
25	20	¾	10	10*	271	<b>167 625 013</b>	0.968	<b>167 625 033</b>	0.990
32	25	1	10	10*	481	<b>167 625 014</b>	1.146	<b>167 625 034</b>	1.156
40	32	1 ¼	10	10*	759	<b>167 625 015</b>	1.897	<b>167 625 035</b>	1.917
50	40	1 ½	10	10*	1263	<b>167 625 016</b>	3.345	<b>167 625 036</b>	3.375
63	50	2	6	6*	1728	<b>167 625 017</b>	4.006	<b>167 625 037</b>	4.054

d (mm)	D (mm)	D1_G (inch)	H (mm)	H1 (mm)	H2 (mm)	H3 (mm)	H4 (mm)	H5 (mm)	H7 (mm)	L (mm)	L2 (mm)	M (mm)	e (mm)	Lift = Hx (mm)
20	68	¾	101	14	12	60	24	16	43	124	25	M6	1.9	7
25	96	¾	132	18	12	73	25	16	57	144	25	M6	2.3	10
32	96	¾	143	22	12	84	25	16	57	154	25	M6	2.9	13
40	120	¾	173	26	15	99	26	26	69	174	45	M8	3.7	15
50	150	¾	214	32	15	119	36	26	88	194	45	M8	4.6	19
63	150	¾	226	39	15	132	36	26	88	224	45	M8	5.8	23

d (mm)	closest inch (inch)
20	¾
25	¾
32	1
40	1 ¼
50	1 ½
63	2

The technical data are not binding. They neither constitute expressly warranted characteristics nor guaranteed properties nor a guaranteed durability. They are subject to modification. Our General Terms of Sale apply.

Georg Fischer Piping Systems Ltd, Postfach, CH-8201 Schaffhausen/Switzerland Phone +41 -(0)52-631 1111 e-mail:

info.ps@georgfischer.com Internet: <http://www.gfps.com>