

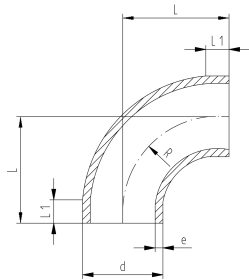

1



2



## PROGEF Standard Bend 90° SDR11/PN10

### Model:

- Material: PP-H
- Conventional butt-welding according to DVS 2207
- IR = Infrared welding compatible

\* Material:PP-R

d (mm)	PN (bar)	FM	Type	Code	Weight (kg)	L (mm)	L1 (mm)	R (mm)	e (mm)
20	10	IR	1	<b>727 018 606</b>	0.008	38	23	15.00	1.90
25	10	IR	1	<b>727 018 607</b>	0.013	42	23	19.00	2.30
32	10	IR	1	<b>727 018 608</b>	0.022	46	22	24.00	2.90
40	10	IR	1	<b>727 018 609</b>	0.040	51	21	30.00	3.70
50	10	IR	1	<b>727 018 610</b>	0.067	58	21	37.00	4.60
63	10	IR	1	<b>727 018 611</b>	0.117	66	21	45.00	5.80
75	10	IR	2	<b>727 018 622</b>	0.178	75	21	71.25	7.25
90	10	IR	2	<b>727 018 623</b>	0.308	90	22	85.50	8.75
110	10	IR	2	<b>727 018 624</b>	0.556	110	25	104.50	10.60
125	10	IR	2	<b>727 018 315</b>	0.952	145	34	127.00	11.40
140	10	IR	2	<b>727 018 316</b>	1.319	162	38	142.00	12.70
160	10	IR	2	<b>727 018 317</b>	1.933	183	40	162.00	14.60
180	10	IR	2	<b>727 018 318</b>	2.621	200	38	182.00	16.40
200	10	IR	2	<b>727 018 319</b>	3.552	220	40	202.00	18.20
225	10	IR	2	<b>727 018 320</b>	5.003	245	41	228.00	20.50
250	10	IR	2	<b>727 018 321</b>	7.080	280	51	253.00	22.70
280	10	IR	2	<b>727 018 322</b>	9.823	310	52	283.00	25.40
315	10	IR	2	<b>727 018 323</b>	14.024	350	61	318.00	28.60
*	355	10	2	<b>727 018 524</b>	16.400	345	70	330.00	32.20
*	400	10	2	<b>727 018 525</b>	22.220	365	70	350.00	36.30
*	450	10	2	<b>727 018 526</b>	32.560	425	70	400.00	40.90
*	500	10	2	<b>727 018 527</b>	44.840	470	90	445.00	45.40

The technical data are not binding. They neither constitute expressly warranted characteristics nor guaranteed properties nor a guaranteed durability. They are subject to modification. Our General Terms of Sale apply.

Georg Fischer Piping Systems Ltd, Postfach, CH-8201 Schaffhausen/Switzerland Phone +41 -(0)52-631 1111 e-mail:  
info.ps@georgfischer.com Internet: <http://www.gfps.com>